

CITY OF
WOLVERHAMPTON
C O U N C I L

Response to Request for Information

Reference EIR 000246
Date 27 September 2018

Public Path Diversion Order

Request:

I am looking to obtain a copy of the map and schedule for the following order which was advertised (FP 493 BURTON CRESCENT TO FIELD STREET) PUBLIC PATH DIVERSION ORDER 2017

[In response to your above question, please find attached information provided on pages 2, 3 and 4.](#)

PUBLIC PATH DIVERSION ORDER
TOWN AND COUNTRY PLANNING ACT 1990 SECTION 257

THE WOLVERHAMPTON CITY COUNCIL (FP493,
BURTON CRESCENT TO FIELD STREET)
PUBLIC PATH DIVERSION ORDER 2017

This Order is made by Wolverhampton City Council under Section 257 of the Town and Country Planning Act 1990 because it is satisfied that it is necessary to divert the length of footpath to which this order relates in order to enable development to be carried out in accordance with planning permission granted under Part III of the Town and Country Planning Act 1990 namely houses and flats and the construction of new estate roads off Burton Crescent, Wolverhampton

BY THIS ORDER

1. The length of footpath over the land shown by bold black dashes on the attached map and described in Part 1 of the Schedule to this order (“the Schedule”) shall be diverted as provided below.
2. There shall be created to the reasonable satisfaction of Wolverhampton City Council an alternative highway for use as a replacement for the said length of footpath as provided in Part 2 of the Schedule shown by a bold black line on the attached map.
3. The diversion of the length of footpath shall have effect on the date on which Wolverhampton City Council certify that the terms of Article 2 above have been complied with.

SCHEDULE

PART 1

Description of site of existing path or way

Footpath 493 commencing at point marked C on the map extending in a generally east-west direction to a point marked B on the map at Burton Crescent

PART 2

Description of site of alternative highway

Footpath 493 commencing at a point marked C on the map and extending in an easterly direction and then to a point marked D on the map at Burton Crescent

Dated: 20 September 2018

Confirmed:

Operative:

THE COMMON SEAL of Wolverhampton
City Council was hereunto affixed in the
presence of:-



Authorised Officer



682/2018

© Copyright of Walker Troup Architects Limited. All rights reserved. No part of this document may be reproduced without the prior written consent of Walker Troup Architects Limited.

SITE AREA - SITES A-D
 12509sqm / 1.25 Hectares
 3.09 Acres

- 1 BFP
- 2 BFP
- 4 BFP
- CAT 2 BUNGALOW
- CAT 3 BUNGALOW

FLATS - 2 storey

- MH 1B2P x 6 No @ 45 sqm - supported
- TYPE J - 1B2P x 4 No @ 55.7-56.5 sqm - Cat 1
- TYPE M - 1B2P x 2 No @ 55.4-56.4 sqm - Cat 1
- 12 No Total Flats @ 32%**

BUNGALOWS - 1 Storey

- TYPE D - 1B2P x 1 No @ 55.8 sqm - Cat 2
- TYPE L - 1B2P x 2 No @ 63.6 sqm - Cat 3
- TYPE K - 1B2P x 2 No @ 67.4 sqm - Cat 3
- TYPE F - 2B4P x 4 No @ 77.4 sqm - Cat 2
- TYPE H - 2B4P x 2 No @ 77.4 sqm - Cat 3
- 11 No Total Bungalows @ 25%**

HOUSES - 2 Storey

- TYPE B - 2B4P x 16 No @ 89.6 sqm
- TYPE C - 4B8P x 04 No @ 125.0 sqm
- 20 No Total Houses @ 43%**
- 43 No TOTAL DWELLINGS**

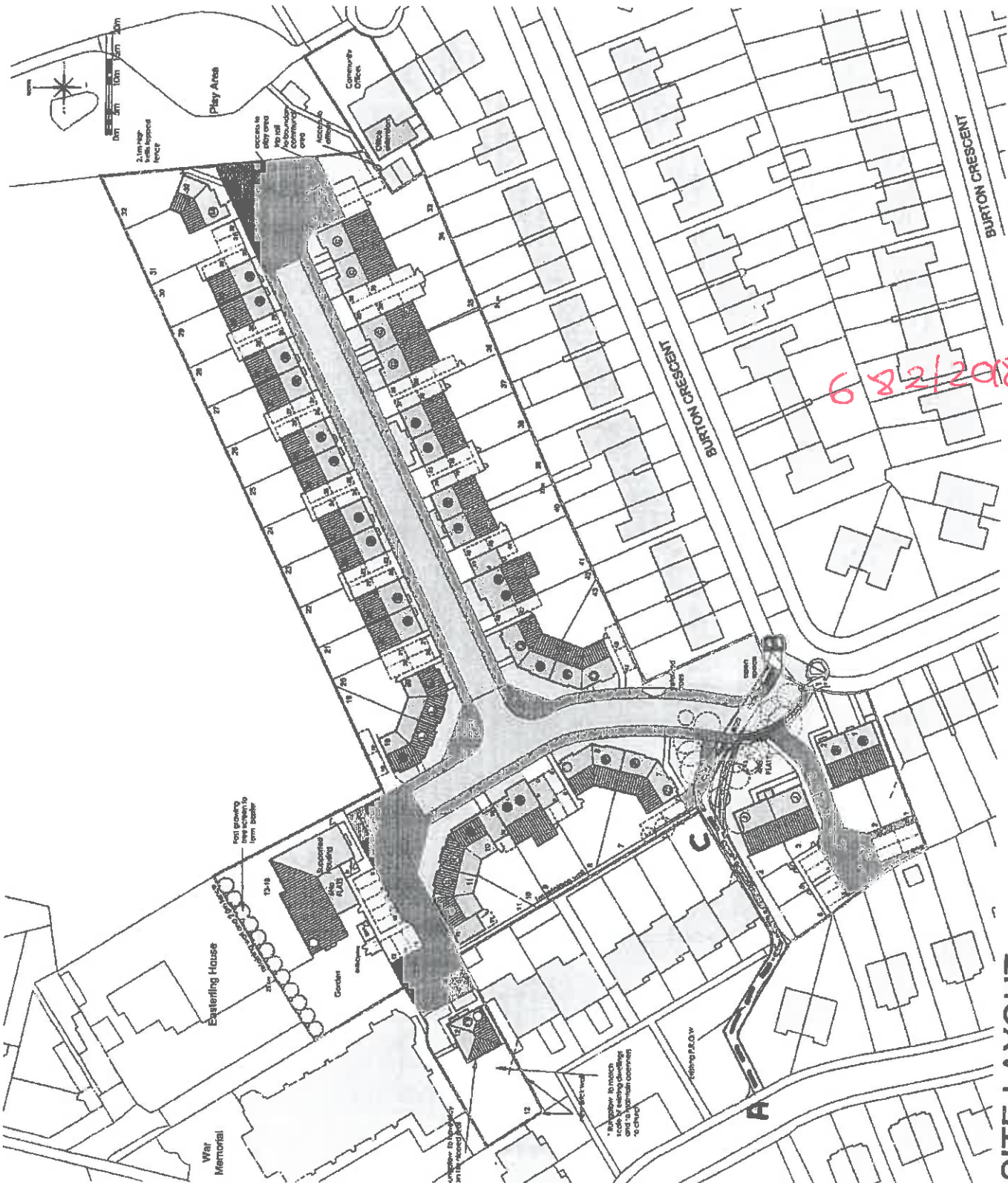

Rev	Date	Description	JW	MB
1	24.8.17	Amended layout to suit conservation / planning comments	JW	MB
2	21.8.17	Amended layout to suit conservation / planning comments	JW	MB
3	07.8.17	Amended layout to suit conservation / planning comments	JW	MB
4	20.7.17	Amended parking to suit highway comments	JW	TH
5	21.5.17	Plans 12 and 20 amended to suit planning comments regarding curtilage, conservation area	JW	TH
Final	Final	Drawings		Drawn

WALKER TROUP ARCHITECTS
 33 Lyndon Road
 Solihull Parkway
 West Midlands B37 8RS
 T: 0121 709 2000
 F: 0121 709 2002
 E: info@walkertroup.co.uk

PROPOSED RESIDENTIAL DEVELOPMENT
BURTON CRESCENT WOLVERHAMPTON

Block Plan

CITY OF WOLVERHAMPTON COUNCIL	
Scale	1:500@A2
Date	04.07.17
Drawn By	JDW
Checked By	VWA
Drawing Number	1708-P-03 E